

MODEL: 60614

PACKING DIAGRAM

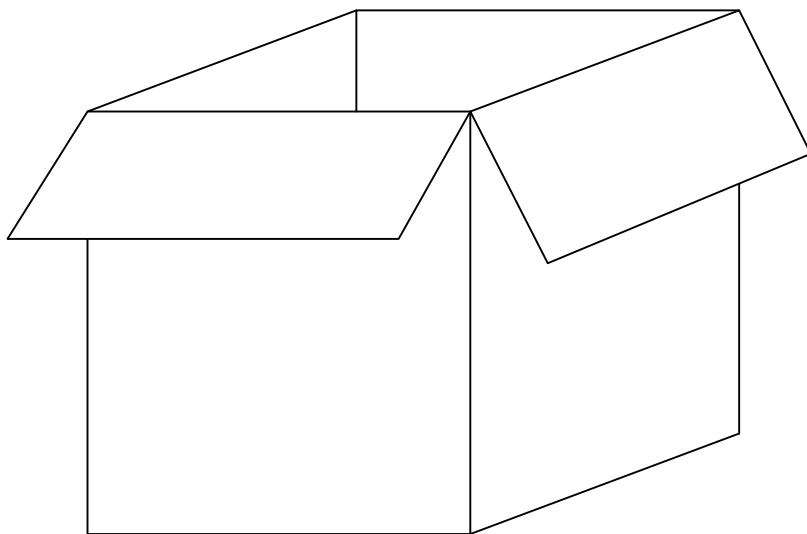
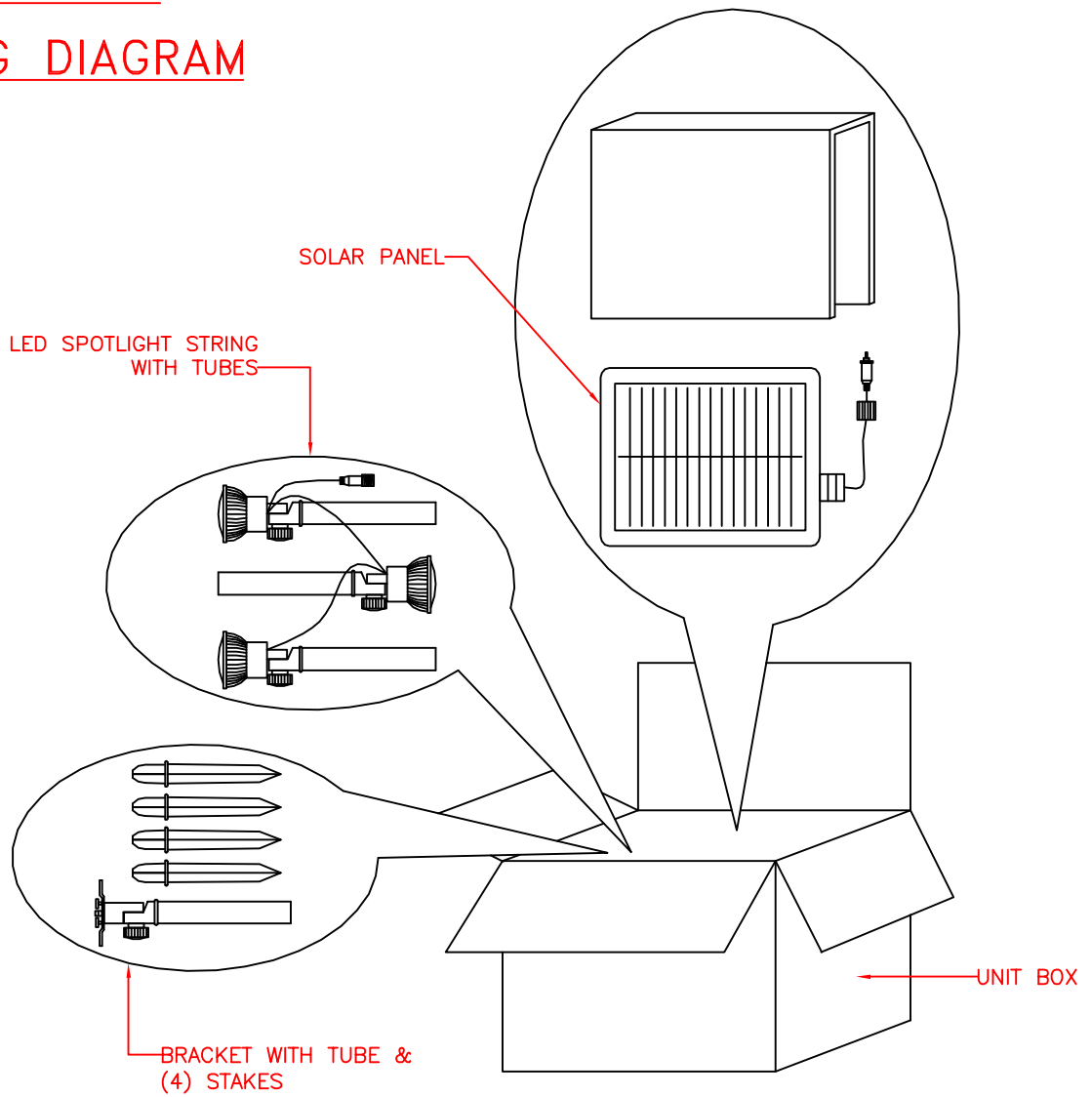

MODEL: 60614

# ASSEMBLY INSTRUCTIONS

## READ AND SAVE THESE INSTRUCTIONS

READ INSTRUCTIONS ALL THE WAY THROUGH PRIOR TO ASSEMBLY.

THIS LED SPOTLIGHT STRING SHOULD TAKE APPROXIMATELY 5 MINUTES TO ASSEMBLE.

MAKE SURE ALL PARTS ARE FIRMLY TIGHTENED.

### UNPACK THE LED SPOTLIGHT

YOU SHOULD HAVE RECEIVED THE FOLLOWING PARTS: SOLAR PANEL, LED SPOTLIGHT STRING WITH TUBES, BRACKET WITH TUBE & (4) STAKES. TO PROTECT THE FINISH, PLACE ALL PARTS ON A SOFT SURFACE.

IDEAL FOR ILLUMINATING STEPS, SHRUBS, FLAGS, ADDRESS MARKERS, FOUNTAINS, STATUARY AND OTHER LANDSCAPE ELEMENTS OUTSIDE OF YOUR HOME OR BUSINESS.

### LED SPOTLIGHT ASSEMBLY

1. JOIN THE TUBE AND STAKE TOGETHER AS SHOWN.

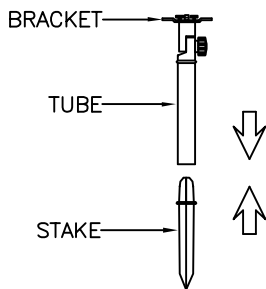

2. ATTACH BRACKET TO BACK OF THE SOLAR PANEL. POSITION BRACKET & SOLAR PANEL AS SHOWN BELOW, WHERE THE TAB IS ON THE BOTTOM OF THE BRACKET & THE SCREW IS ON THE SAME SIDE AS THE POWER BUTTON ON THE SOLAR PANEL, THE BRACKET WILL LOCK ON TO THE CONNECTOR ON THE BACK OF THE SOLAR PANEL BY PRESSING THE TAB AGAINST THE BACK OF THE PANEL & SLIDING THE BRACKET UPWARD, FOLLOW ARROWS ON DIAGRAM.

**NOTE:** YOU CAN ADJUST THE ANGLE OF THE SOLAR PANEL BY LOOSING THE SCREW.

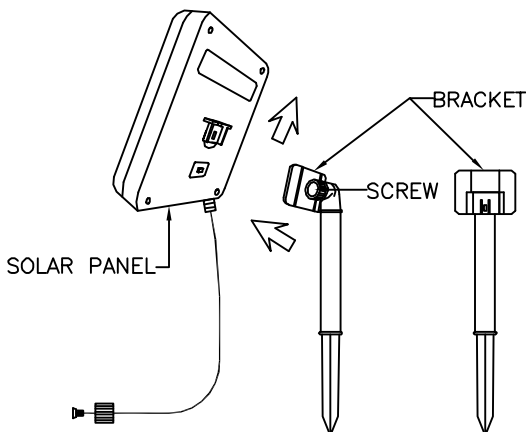

3. JOIN THE TUBE AND STAKE TOGETHER.

NOTE: YOU CAN ADJUST THE ANGLE OF THE LED SPOTLIGHT BY LOOSING THE SCREW.

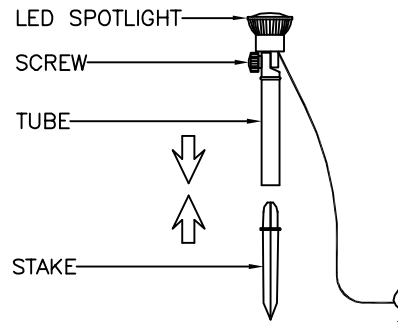

4. THEN INSERT STAKES OF LED SPOTLIGHT INTO GROUND, INSERT STAKE OF SOLAR PANEL INTO GROUND IN A SUNNY AREA, MAKE SURE SOLAR PANEL IS NOT IN SHADOW AND RECEIVING DIRECT SUNLIGHT.

5. JOIN THE CONNECTORS AND SCREW THE CAP TIGHTLY TOGETHER.

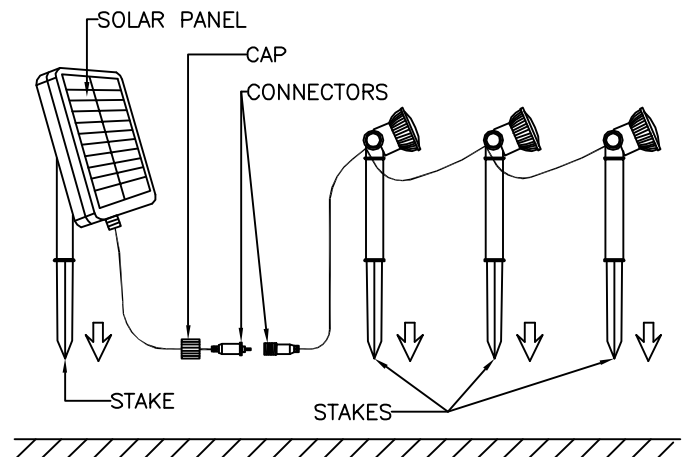

6.) SLIDE THE SWITCH TO "ON" POSITION FOR CHARGING, ONCE CHARGED FOR AROUND 10 HOURS, YOUR NEW SOLAR LED LIGHT STRING IS READY FOR USE.

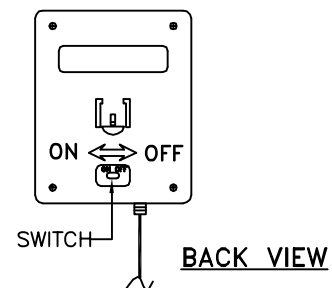

### NOTE:

- 1). FULL CHARGE TIME: 10 HOURS.
- 2). WORKING TIME AFTER FULL CHARGE: 7 HOURS.
- 3). THE SERVICE LIFE OF BATTERY: 500 TIMES.

MODEL: 60614

## ASSEMBLY INSTRUCTIONS

READ AND SAVE THESE INSTRUCTIONS

IF NECESSARY, PLEASE SEE THE FOLLOWING STEPS TO REPLACE THE RECHARGEABLE BATTERY.

- 1.) REMOVE (4) SCREWS FROM BACK OF SOLAR PANEL WITH SCREWDRIVER (NOT INCLUDED).

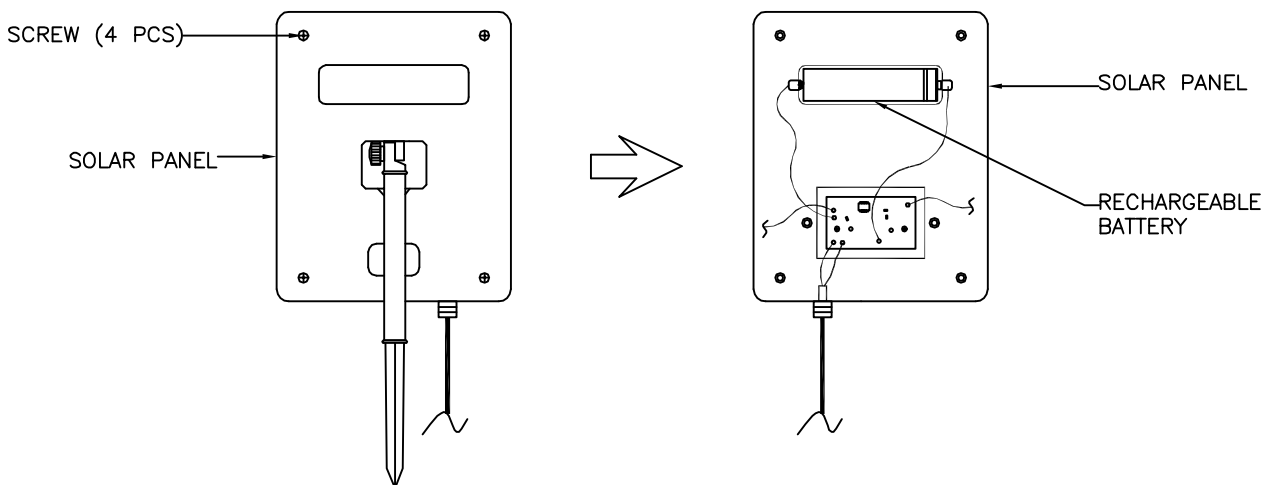

- 2.) REMOVE THE OLD BATTERY AND REPLACE WITH A NEW RECHARGEABLE BATTERY (2000MAH, 3.7V, LION-18650), REPLACE THE COVER AND SECURE WITH (4) SCREWS.

### TROUBLE SHOOTING

1.) IF YOUR PATH LIGHTS ARE NOT FUNCTIONING PROPERLY OR LOSING POWER MID-CYCLE, THEN ENSURE THE SOLAR PANEL IS POSITIONED IN DIRECT SUNLIGHT. YOUR SOLAR PANEL WILL NEED TO COLLECT ABOUT 10 HOURS OF SUNLIGHT TO FUNCTION THROUGHOUT A FULL CYCLE.

2.) ALTHOUGH THE BATTERY INSIDE YOUR SERIOUSLY SOLAR PANEL IS DESIGNED FOR MAXIMUM LONGEVITY, OVERTIME PERFORMANCE WILL DROP – REPLACING THE BATTERY WILL CORRECT THIS ISSUE.

### IMPORTANT NOTES:

1.) THE LED LIGHT WILL TURN ON AUTOMATICALLY AT DUSK IF THE SWITCH IS IN "ON" POSITION, LASTS 10 HOURS AFTER FULL CHARGE.

2.) ALTHOUGH THERE MAY BE SOME INITIAL CHARGE IN BATTERY, WE RECOMMEND FULLY CHARGING IT BEFORE FIRST USE. TURN ON THE LED LIGHT AND LEAVE THE SOLAR PANEL IN GOOD SUNLIGHT FOR 10 HOURS TO ENSURE THE BATTERY IS FULLY CHARGED.

3.) TO MAXIMIZE SOLAR ENERGY INTAKE, THE SOLAR PANEL MAY BE CLEANED PERIODICALLY WITH A SOFT RAG AND WATER, DO NOT USE CHEMICAL SOLVENTS.